

M42 x 1
Flange - detector distance
10,56 mm

Phase adjustment

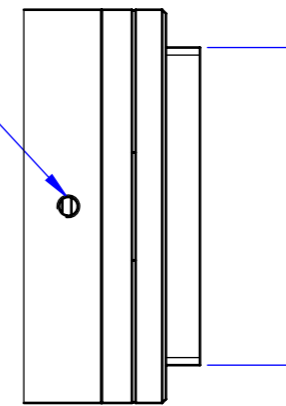

DETAIL D
SCALE 1 : 1

Rev No.	Description	Date	Name

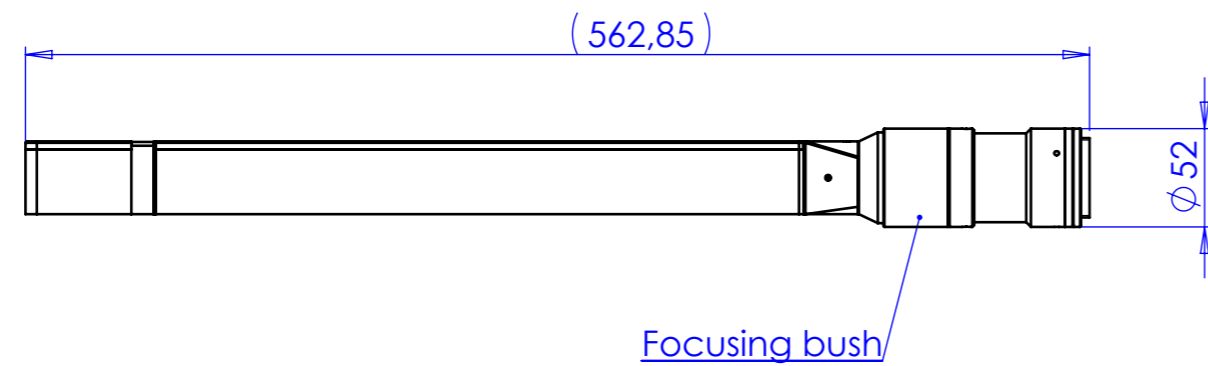

Material		N.A.		Mass		g 3955		Scale		1:4	
Surface treatment		N.A.		Part No.		CO71531					
Geometrical tolerance (ISO 2768-2)				Class		K		Undimensioned bevels		0,5x45°	
Linear tolerance (ISO 2768-2)				Class		m		Undimensioned radii		R 0.5	
0.5	>3	>6	>30	>120	>400	>1000	>2000	Description TC4K180-N			
±3	6	30	120	±400	1000	±2000	±4000				
±0.1	±0.1	±0.2	±0.3	±0.5	±0.8	±1.2	±2				
all dimensions are in mm											
<p>OPTO ENGINEERING THE TELECENTRIC COMPANY</p>		Date		Name		Drawing No.		Sheet			
		Designed		16/04/2014		Santini		DP 71531 -A			
		Drawn		23/05/2014		Rodella					
Checked											
<p>OPTO ENGINEERING S.r.l. - Mantova Italy - Tel. +39 0376 699111 - www.opto-engineering.com</p> <p><i>Secret and confidential - All rights reserved - No copy, dissemination or circulation is allowed unless specifically authorized in writing by OPTO ENGINEERING S.r.l. - Any violation shall be legally prosecuted.</i></p>											